

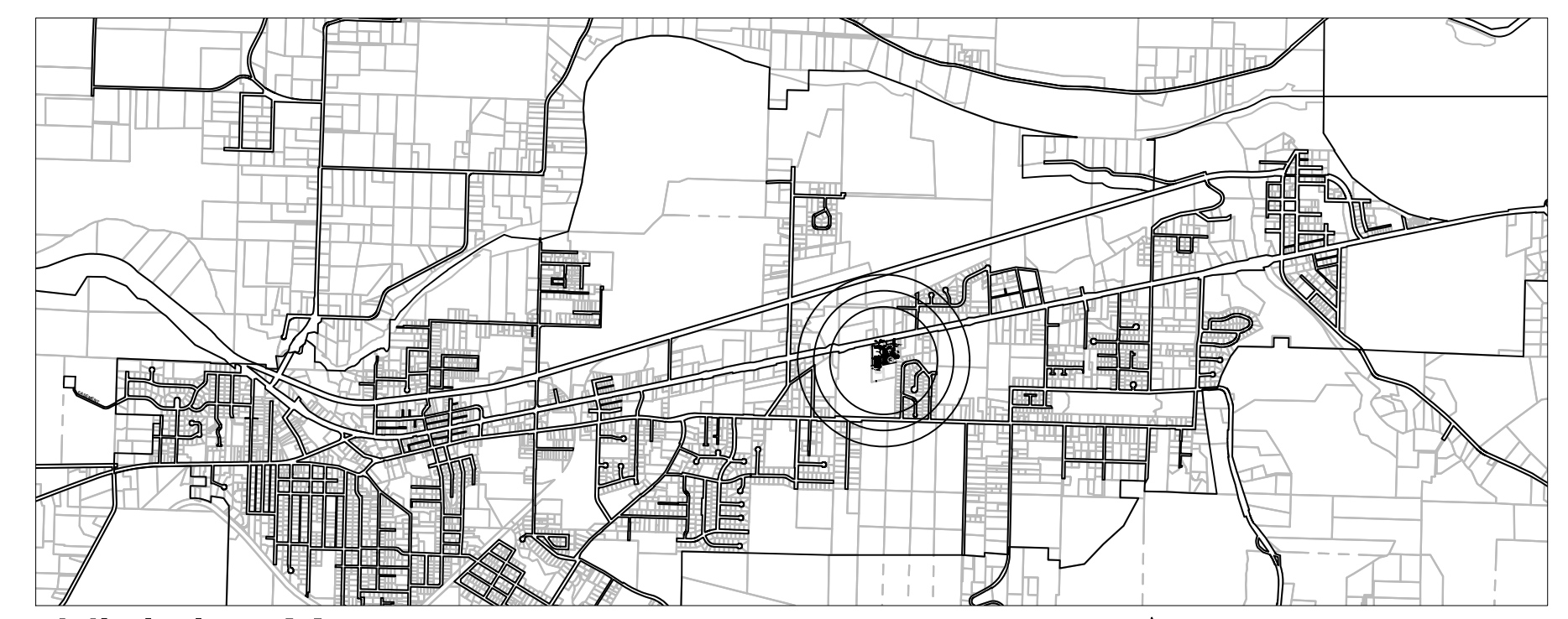

Digitally signed by Sid Scott  
 Date: 2018.07.30 11:58:58-0700

## SWEET HOME CITY HALL

3225 MAIN STREET  
 SWEET HOME, OREGON 97386



Vicinity Map  
 Horizontal Scale 1" = 400'

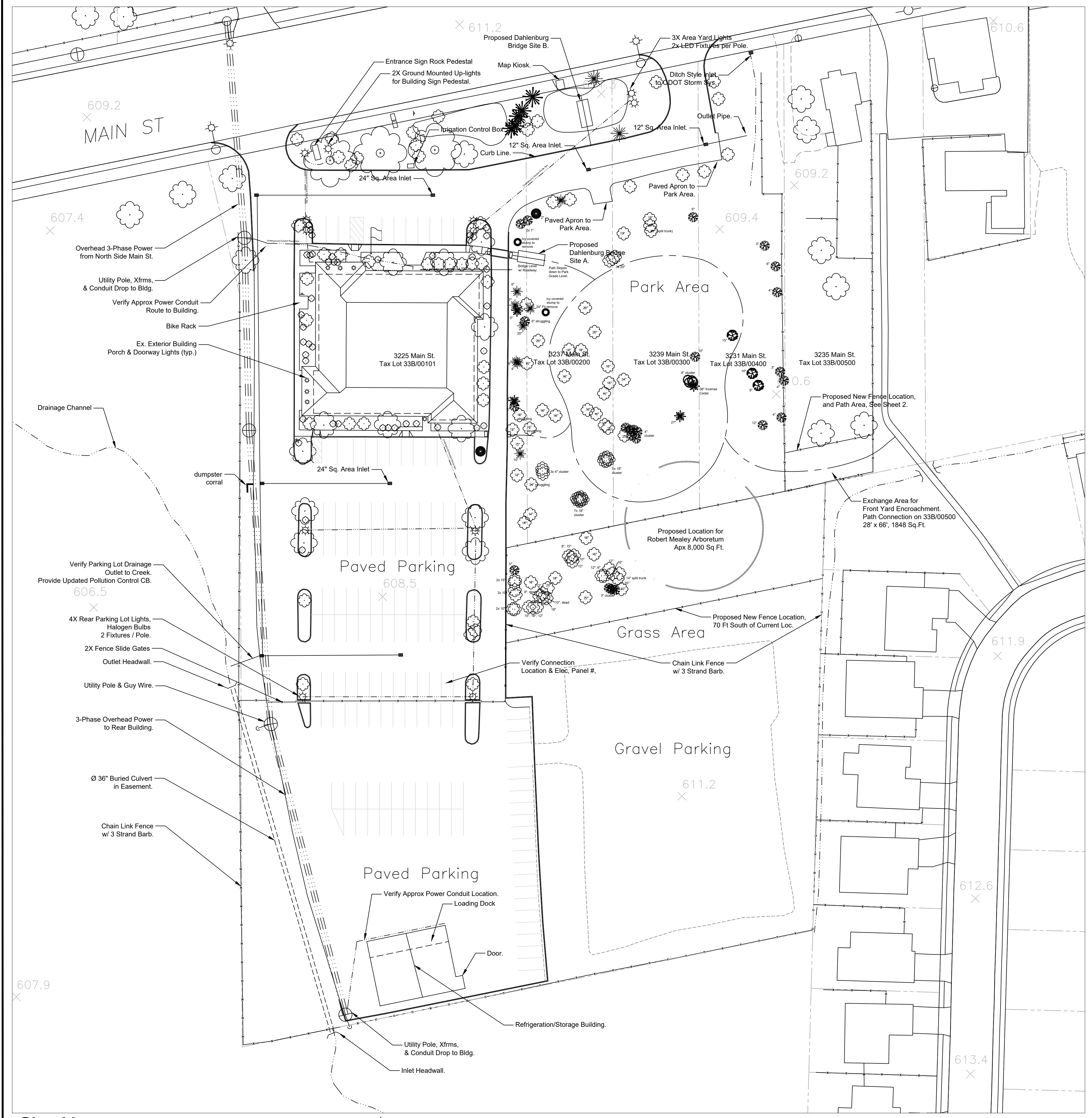

Site Map  
 Horizontal Scale 1" = 40'

### SITE PLAN

- THIS DRAWING:**
- SITEWORK SCOPE OF WORK IS GENERALLY LIMITED TO MINOR WORK IMMEDIATELY ADJACENT TO BUILDING AND DEFINED BY BUILDING DRAWINGS.
  - THIS SITE DRAWING PROVIDED BY OWNER - CITY OF SWEET HOME, FOR REFERENCE ONLY - PARTICULARLY EXISTING SITE UTILITIES.
- CONTRACTOR SCOPE:**
- SEE DRAWINGS AND SPECIFICATION FOR ELECTRICAL SCOPE OF WORK - GENERALLY REPLACING BUILDING ELECTRICAL WORK FROM POINT-OF-CONNECTION. (BIDDER-DESIGN SYSTEM.)
  - THIS SITE DRAWING PROVIDES AN OVERVIEW OF EXISTING SITE ELECTRICAL COMPONENTS.
  - WHILE SITE ELECTRICAL IS GENERALLY BEYOND CONTRACTOR SCOPE OF WORK, BIDDER-DESIGN ELECTRICAL SYSTEM SHALL PROVIDE CAPACITY FOR, AND CONNECTION OF, EXISTING SITE ELECTRICAL COMPONENTS AS INDICATED THIS DRAWING.

#### LEGEND:

- |   |  |   |  |
|---|--|---|--|
| ⊙ | Driveway location, flare out 3' radius at edge of roadway. | ↗ | Pavement Slope                           |
| ↗ | Pavement Slope   | ▨ | 4" Pavement Depth, AC Class C / Level 2. |
| ▨ | 2" Pavement Depth, AC Class C / Level 2 Overlay.           | ▩ | Concrete Driveway, poor condition.       |
| ▩ | 4" Pavement Depth, AC Class C / Level 2 Overlay.           | ▧ | Concrete Sidewalk, poor condition.       |
| ▧ | 1.5" Pavement Depth, AC Class C / Level 2 Overlay          | ⊕ | Valve                                    |
| ▦ | 1.5" - 0" Pavement Grinding, 6.0 ft wide each side.        | ⊙ | Manhole                                  |
| ⊕ | Valve  | ○ | Cleanout                                 |
| ⊙ | Manhole  | ⊕ | Fire Hydrant                             |
| ○ | Cleanout   |   |  |

**Attention:** Oregon law requires you to follow rules adopted by the Oregon Utility Notification Center. Those rules are set forth in OAR 952-001-0010 through OAR 952-001-0090. You may obtain copies of the rules by calling the center. (Note: the telephone number for the Oregon Utility Notification Center is (503) 232-1987. The Locate number is 811.

Drawing:  
**SITE PLAN**

Job No: 16158  
 Date: JULY 27, 2018  
 Drawn By:  
 Checked By:  
 Sheet No: