

**RESOLUTION NO. 3 FOR 1996**

A RESOLUTION PROPOSING THE REDESIGNATION OF THE SWEET HOME ENTERPRISE ZONE.

WHEREAS, the City of Sweet Home/Linn County is sponsoring an application for redesignation of an enterprise zone; and

WHEREAS, the City/County is interested in redesignation of an enterprise zone to encourage new business investment, job creation, higher incomes for local residents, greater diversity of economic activity; and

WHEREAS, the proposed enterprise zone is depicted on the drawn-to-scale maps (Exhibits A and B) to be included in the application; it has a total area of 7.35 square miles, and it meets other statutory limitations on size and configuration. Exhibit C is the legal description for that area beyond the urban growth boundary as depicted in Exhibit B; and

WHEREAS, the proposed enterprise zone contains significant land that is designated for industrial use as indicated by the comprehensive plan map of industrial lands and verification of acknowledgment by the Land Conservation and Development Commission, included in the application (Exhibit D), and that is sufficiently accessible, serviced or serviceable, and ready for use and further development; and

WHEREAS, the City/County appreciates the impacts that a redesignated enterprise zone would have and the property tax exemptions that eligible business firms might receive therein, as governed by Oregon Revised Statutes (ORS) 285.560 to 285.617 (1995); and

WHEREAS, this is a pre-existing enterprise zone of which no changes are being proposed to the boundaries and which is located in an economically distressed area.

NOW, THEREFORE, BE IT RESOLVED that the City County proposes and applies for redesignation of an Oregon enterprise zone to be named: The Sweet Home Enterprise Zone.

Dan J. Dean, City Manager, is authorized to submit the application from the City/County and to make any and all substantive or technical changes to the application materials, as necessary, after adoption of this resolution.

The City/County will give priority to the use in the proposed enterprise zone, if redesignated, of any economic development or job training funds received from the federal government.

The City/County jointly appoints Dan J. Dean as the enterprise zone manager.

The City/County will jointly comply with the requirements and provisions of ORS 285.577.

The City/County commits to prepare, within six months of designation, a list and map of local lands and buildings owned by the state or by municipal corporations within the proposed enterprise zone that are not being used or designated for a public purpose and that have appropriate land use zoning, and to do whatever is possible in order to make such real property available for lease or purchase by precertified or qualified business firms.

The City/County requests pursuant to OAR 123-065-0020(9) that the Sweet Home Enterprise Zone be redesignated as a continuation of the current Sweet Home Enterprise Zone, and that the policies and appointments of the terminated Zone also continue.

PASSED by the Council and approved by the Mayor this 13th day of February, 1996.

  
\_\_\_\_\_  
Mayor

ATTEST:

  
\_\_\_\_\_  
City Manager - Ex Officio City Recorder

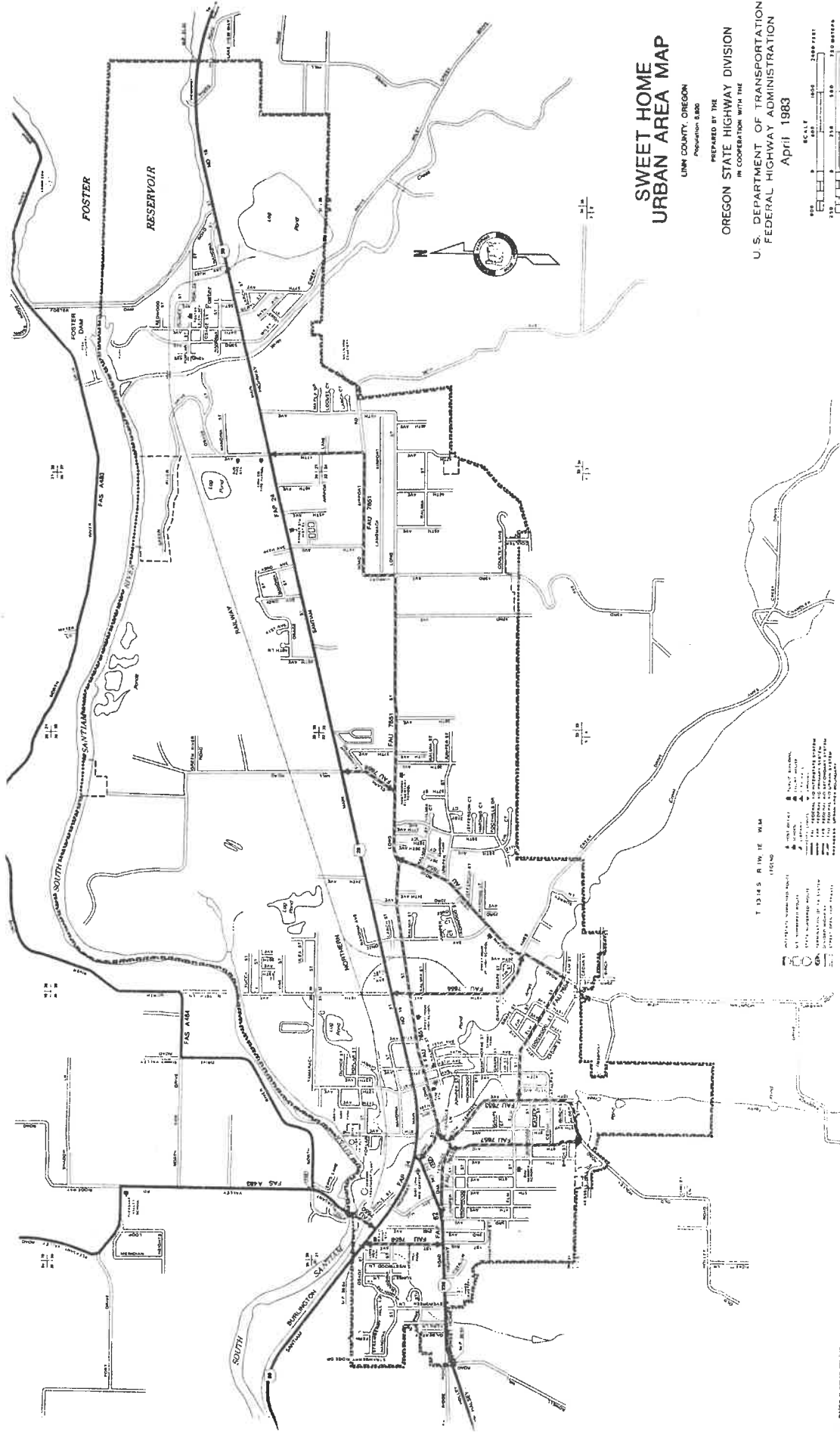

# SWEET HOME URBAN AREA MAP

LINN COUNTY, OREGON  
Population 8,800

PREPARED BY THE  
OREGON STATE HIGHWAY DIVISION

IN COOPERATION WITH THE  
U. S. DEPARTMENT OF TRANSPORTATION  
FEDERAL HIGHWAY ADMINISTRATION  
April 1983

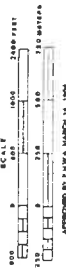

APPROVED BY FHWA, MARCH 14, 1983

T 13145 R 1 W 1 E W 1/4  
112000

- LEGEND
- ▲ FUTURE DEVELOPMENT
  - ▲ EXISTING DEVELOPMENT
  - ▲ EXISTING BUILDINGS
  - ▲ EXISTING UTILITIES
  - ▲ EXISTING STREETS
  - ▲ EXISTING RAILROADS
  - ▲ EXISTING AIRPORTS
  - ▲ EXISTING WATERWAYS
  - ▲ EXISTING PARKS
  - ▲ EXISTING ZONING
  - ▲ EXISTING LAND USE
  - ▲ EXISTING PLANNING
  - ▲ EXISTING TRANSPORTATION
  - ▲ EXISTING UTILITIES
  - ▲ EXISTING STREETS
  - ▲ EXISTING RAILROADS
  - ▲ EXISTING AIRPORTS
  - ▲ EXISTING WATERWAYS
  - ▲ EXISTING PARKS
  - ▲ EXISTING ZONING
  - ▲ EXISTING LAND USE
  - ▲ EXISTING PLANNING
  - ▲ EXISTING TRANSPORTATION

ENTERPRISE ZONE

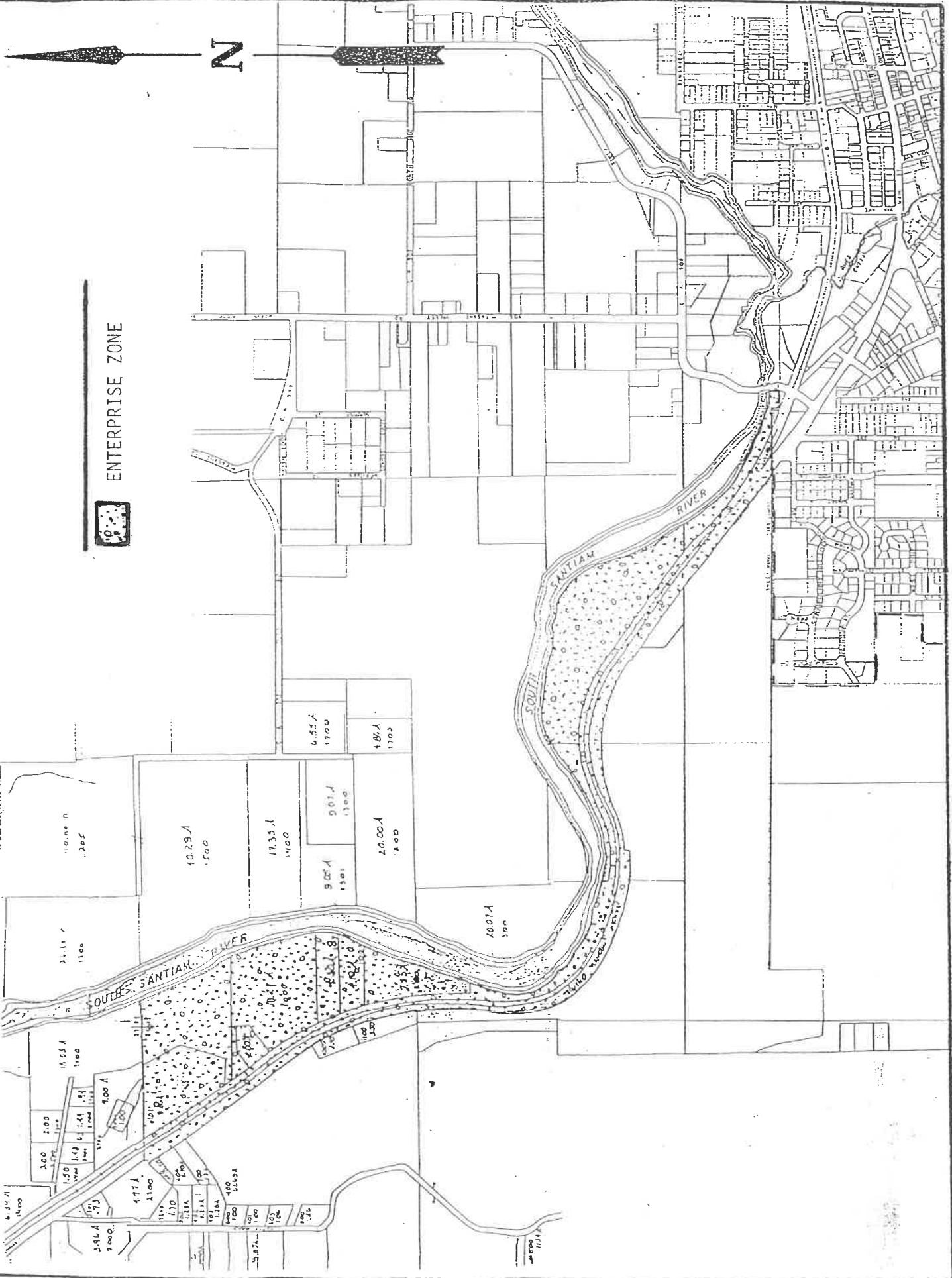

Exhibit "C"

The following described area is proposed to be added to the Sweet Home Enterprise Zone:

Beginning at the Northeast corner of the Lowell Ames, Sr. Donation Land Claim #48, Township 13 South, Range 1 East, Willamette Meridian, Linn County, Oregon; running thence West on the North line of said Donation Land Claim #48 to Southwesterly right-of-way line of State Highway #20 as relocated; thence Northwesterly on said right-of-way to the North line of Section 26, Township 13 South, Range 1 West, Willamette Meridian; thence East on the North line of said Section 26, to the Northeast corner of said Section 26; thence East on the North line of Section 25, Township 13 South, Range 1 West, Willamette Meridian to Easterly highwater mark of the South Santiam River; thence Southeasterly on the Easterly highwater mark of the South Santiam River to the Westerly right-of-way line of County Road #906 (Pleasant Valley Road); thence Southerly on the Westerly right-of-way line of said County Road #906 to the North line of the Lowell Ames, Jr. Donation Land Claim #47 in Township 13 South, Range 1 East, Willamette Meridian; thence West on the North line of said Donation Land Claim #47 to the Northwest corner of said Donation Land Claim #47; thence North to the place of beginning.

I, hereby certify that the above described description is correct for the proposed amendment to Sweet Home, Oregon Enterprise Zone.



Linn County Surveyor  
Oregon Professional Land Surveyor #431

Dated: January 28, 1992

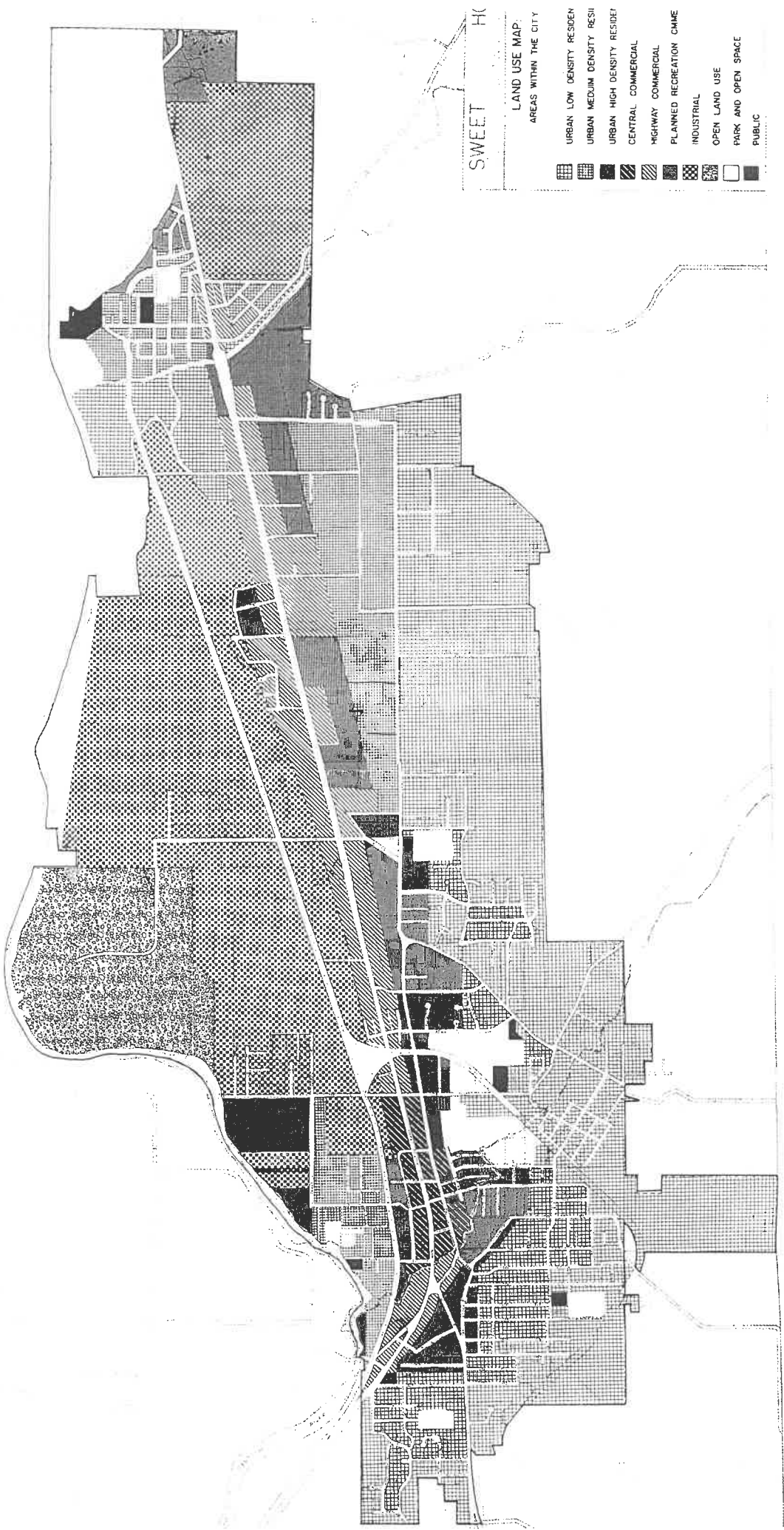

COMPT PLAN